



## 13 Baringa Road Earlwood NSW

5 3 3

Nestled in the heart of the sought-after suburb of Earlwood, this captivating residence is a perfect blend of contemporary luxury and family-friendly functionality. Boasting five bedrooms, three bathrooms, a double garage, and a sparkling pool, this property offers the ideal haven for modern living. Situated in Earlwood, enjoy the convenience of nearby schools, parks, and local amenities. Easy access to transport links ensures a connected lifestyle.

**Building Size** : 269 sqm  
**Land Size** : 585 sqm  
**View** : <https://www.swpre.com.au/7946312>



**Faraz Pierzad**  
0452 405 682



GROUND LEVEL FLOOR PLAN



FIRST LEVEL FLOOR PLAN

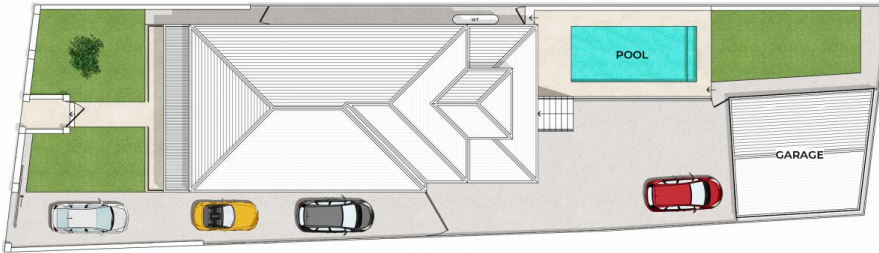

SITE PLAN

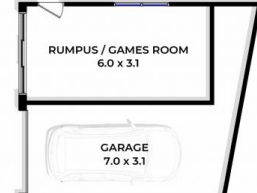

GARAGE FLOOR PLAN



13 Baringa Road, Earlwood



Sydney Wide Property

This diagram is for illustrative purpose only. All reasonable care has been taken in the preparation, but no warranty is given as to the accuracy of the information. This document does not constitute any part of any offer or contract. Dimensions shown are approximate only. Prospective purchasers must rely on their own enquiries. Floor plan by INFP 0410581805 / spnplix.com.au



GROUND LEVEL FLOOR PLAN



FIRST LEVEL FLOOR PLAN

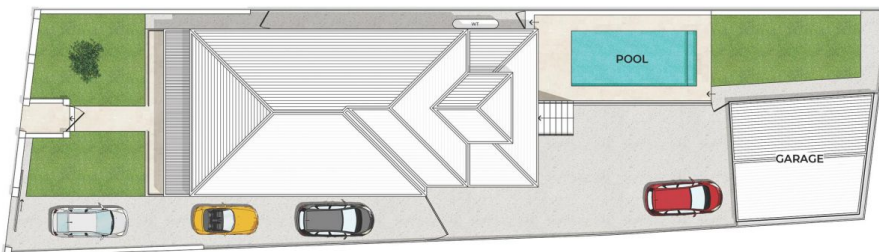

SITE PLAN

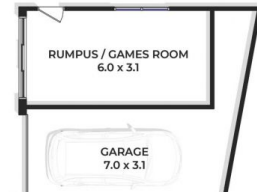

GARAGE FLOOR PLAN



13 Baringa Road, Earlwood



Sydney Wide Property

This diagram is for illustrative purpose only. All reasonable care has been taken in the preparation, but no warranty is given as to the accuracy of the information. This document does not constitute any part of any offer or contract. Dimensions shown are approximate only. Prospective purchasers must rely on their own enquiries. Floor plan by INFP 0410581805 / spnplix.com.au