



17 Sloane Street MARRICKVILLE NSW



Freshly painted and re carpeted.

Factory Area: 255sqm

Office Area: 72sqm

Total Area: 327sqm

Outgoings: Building Insurance only

Available now to inspect

Type : Industrial
Building Size : 395 sqm
View : <https://www.swpre.com.au/8128480>



Aris Giotas
0452 405 682

17 SLOANE STREET, MARRICKVILLE

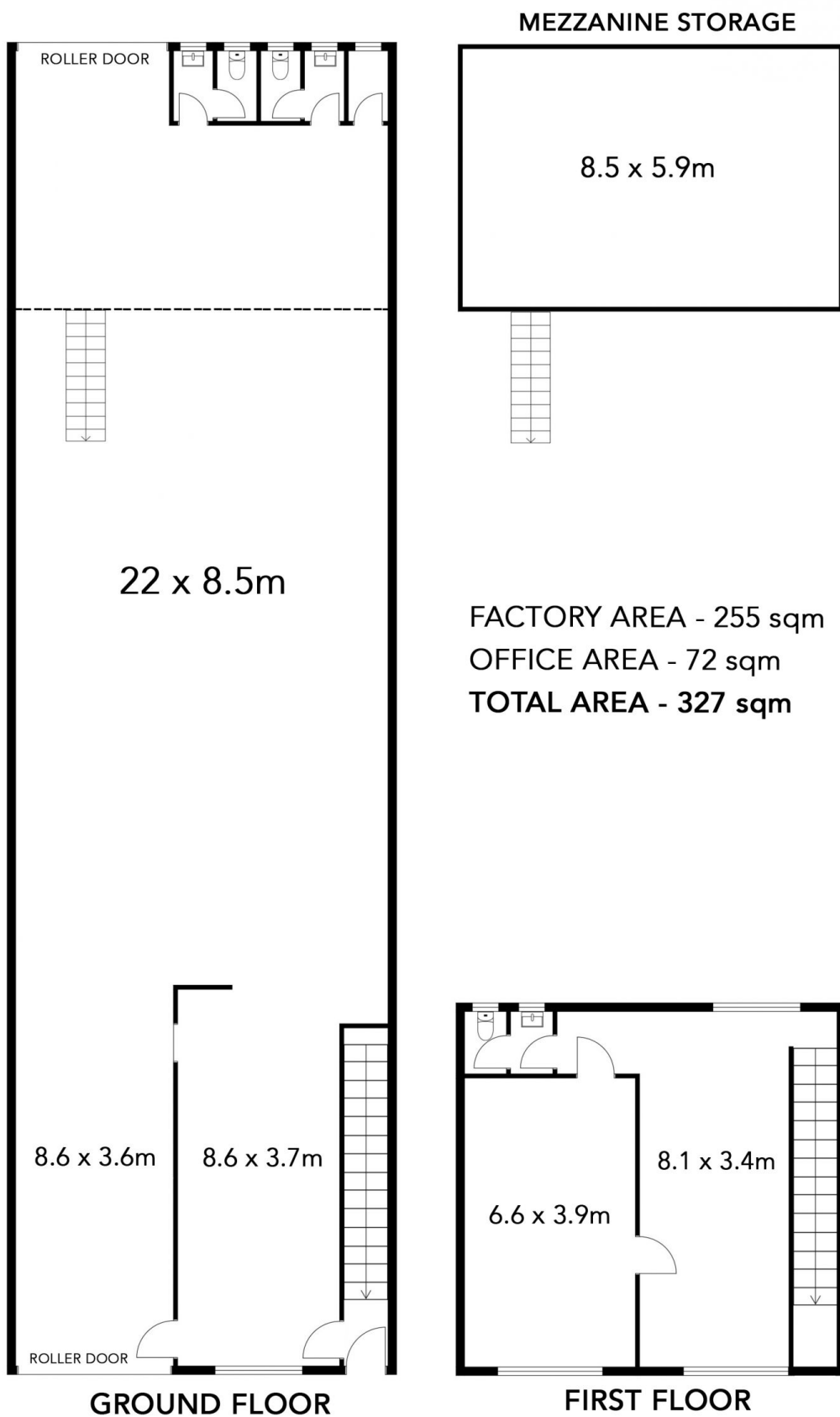

Plans shown are for presentation purposes only and are not part of any legal document or title. They are subject to errors, omissions and inaccuracies. They should not be used as a sole and accurate reference. Interested parties should make their own inquiries using independent sources.