



## 17 Sloane Street Marrickville NSW



Excellent opportunity to secure a free-standing factory in vibrant Marrickville. This property features, first floor offices, with two access, rear lane, making it perfect for various industrial uses. Benefit from a secure premises and in a prime location with great connectivity. walk to Sydenham Railway and Metro station.

Factory Area: 255 sqm  
Office Area: 72 sqm  
Total Area: 327 sqm approx.  
Zoning: E4 General Industrial

**Type** : Industrial  
**Building Size** : 395 sqm  
**View** : <https://www.swpre.com.au/8129074>



**Aris Giotas**  
0452 405 682

# 17 SLOANE STREET, MARRICKVILLE

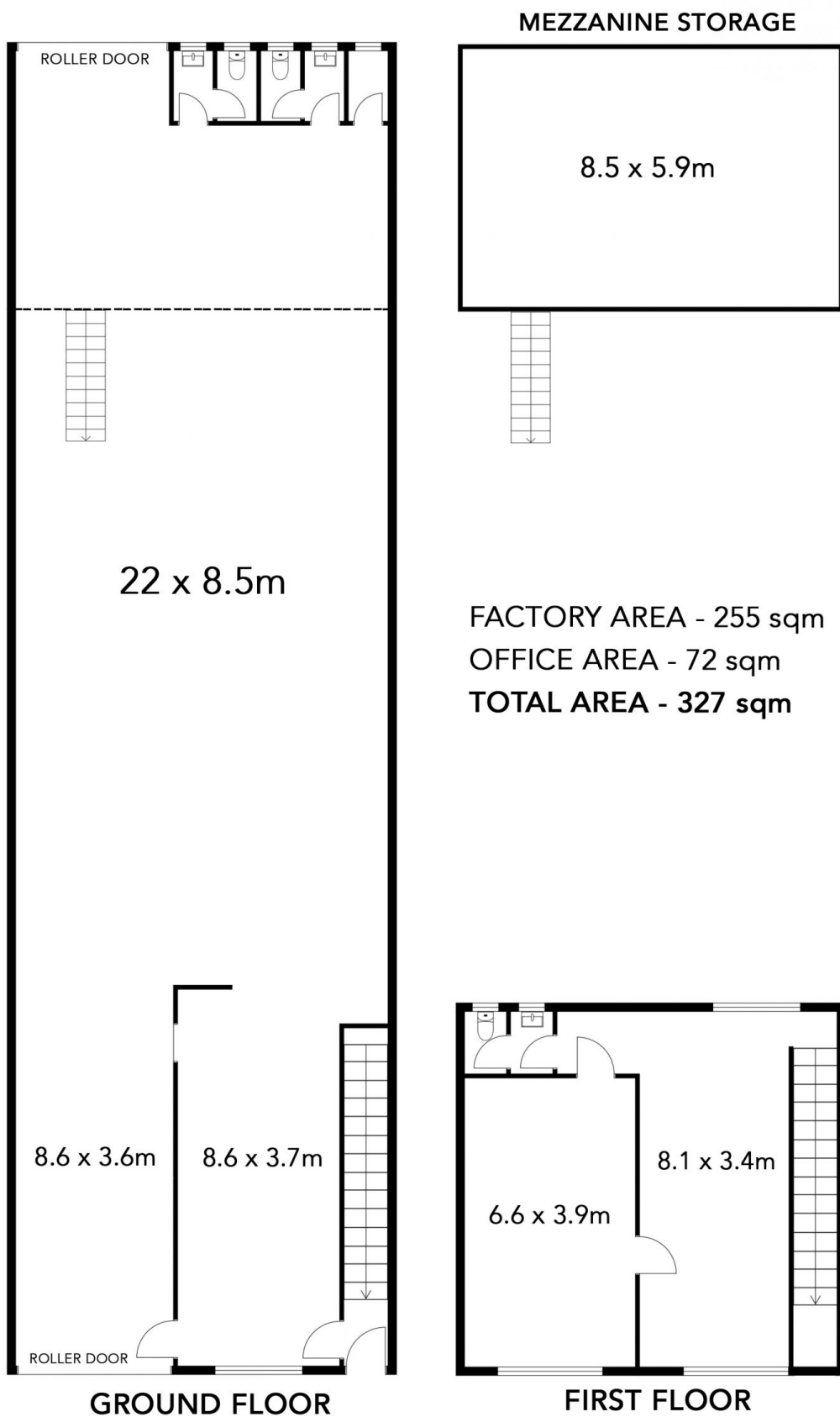

Plans shown are for presentation purposes only and are not part of any legal document or title. They are subject to errors, omissions and inaccuracies. They should not be used as a sole and accurate reference. Interested parties should make their own inquiries using independent sources.