



214 McLaughlin Road Gundry NSW

Discover the charm of 214 McLaughlin Road, Gundry - an expansive 80-acre approx retreat set in tranquil surroundings. This secure, fully fenced property offers the perfect escape for those seeking off-the-grid living. The cozy 2-bedroom weekender is ideal for a peaceful getaway. Step out onto the veranda, crafted from locally sourced timbers, and take in breathtaking views of the pristine bushland.

While this property is perfect for a tiny home or off-the-grid retreat, it currently does not have a permanent building entitlement. Numerous dirt tracks wind through the property, perfect for adventurous exploration, while solar power and woodfire heating offer a sustainable lifestyle.

Type : Rural
Price : Price guide: \$650,000
Land Size : 31.07 ha
View : <https://www.swpre.com.au/8200661>



Aris Giotas
0452 405 682



David Glucksman
0452 405 682

[For full version visit the website](https://www.swpre.com.au)

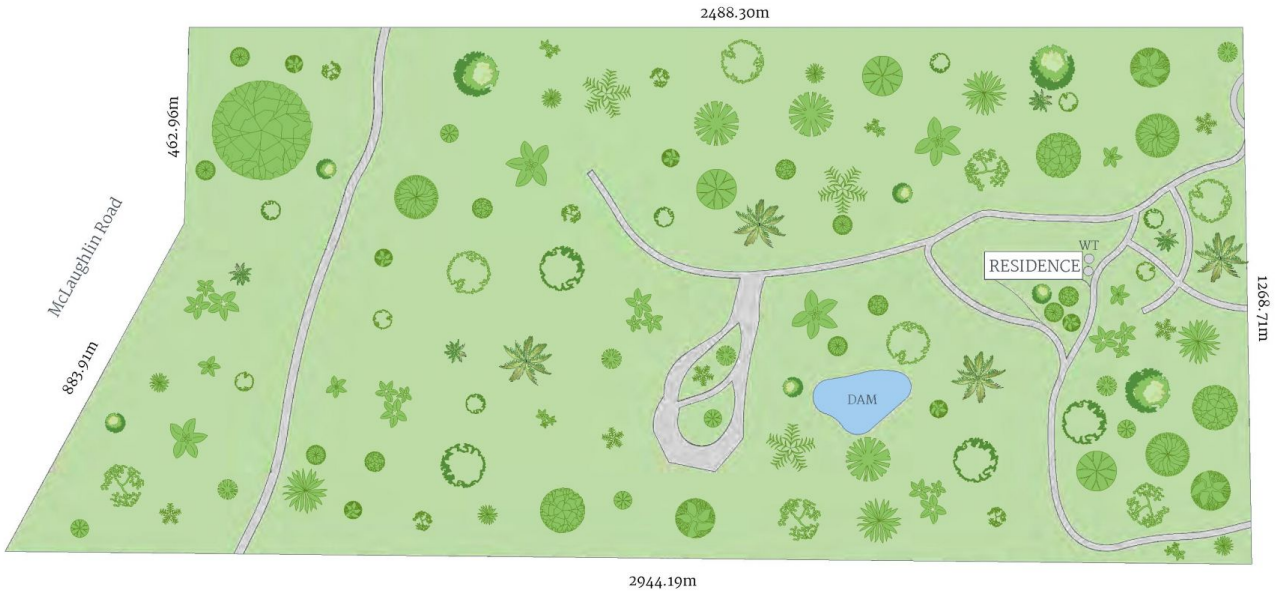

214 MCLAUGHLIN ROAD, GUNDARY

Scale shown in metres. All dimensions herein are approximate and gathered from sources believed to be reliable. Whilst every effort is made for the accuracy of our floor plans, interested parties should rely on their own enquiries.



Land Area 310,685sqm